

CONCEPT PLAN PACKAGE
Site 4
Hackensack Plank Road/Palisade Avenue/30th Street
(Union City)

- List of Issues/Proposed Improvements
- Aerial
- Problems/Issues Map
- Improvement Concept Plan
- Preliminary Cost Estimate

North Hudson Pedestrian and Bicycle Concept Plans Final Report

Hackensack Plank Road, Palisade Avenue and 30th Street

Problems/Issues

- Very long pedestrian crossing.
- Pedestrian signal head obscured by chain link fence from view across 30th Street.
- Significant volumes of pedestrian traffic.

Improvement Concepts

- Adjust fencing to not obstruct existing pedestrian signal head.
- Provide detectable warning across all curb ramps.
- Realign crosswalk to decrease crossing distance and match typical pedestrian pattern.
- Provide curb extension to decrease pedestrian crossing distance and improve visibility (use French Drain and Grating to maintain existing drainage pattern).



View southbound across Palisade Avenue



View southbound along 30th Street



View southbound on 30th Street



View across 32nd Street



PLANS PREPARED FOR:

The RBA Group
 ENGINEERS • ARCHITECTS • PLANNERS
 One Evergreen Place
 Morristown, New Jersey 07962
 N.J. AUTHORIZATION CERTIFICATE NO. 24GA27930500
 Phone (973) 898 0300, Fax (973) 898-9472

REVISIONS

NO.	DATE	COMMENTS

NORTH HUDSON COUNTY -
 BICYCLE AND PEDESTRIAN STUDY
 HACKENSACK PLANK RD.
 AND PALISADE AVENUE
 AND 30th STREET



DATE:
 JOB NUMBER: J3536.00
 SCALE: 1"=50'
 DRAWN BY:
 CHK. BY:
 SHEET NUMBER

PLOT DATE: 04/28/2005
 PLOT TIME: 01:55:31 PM

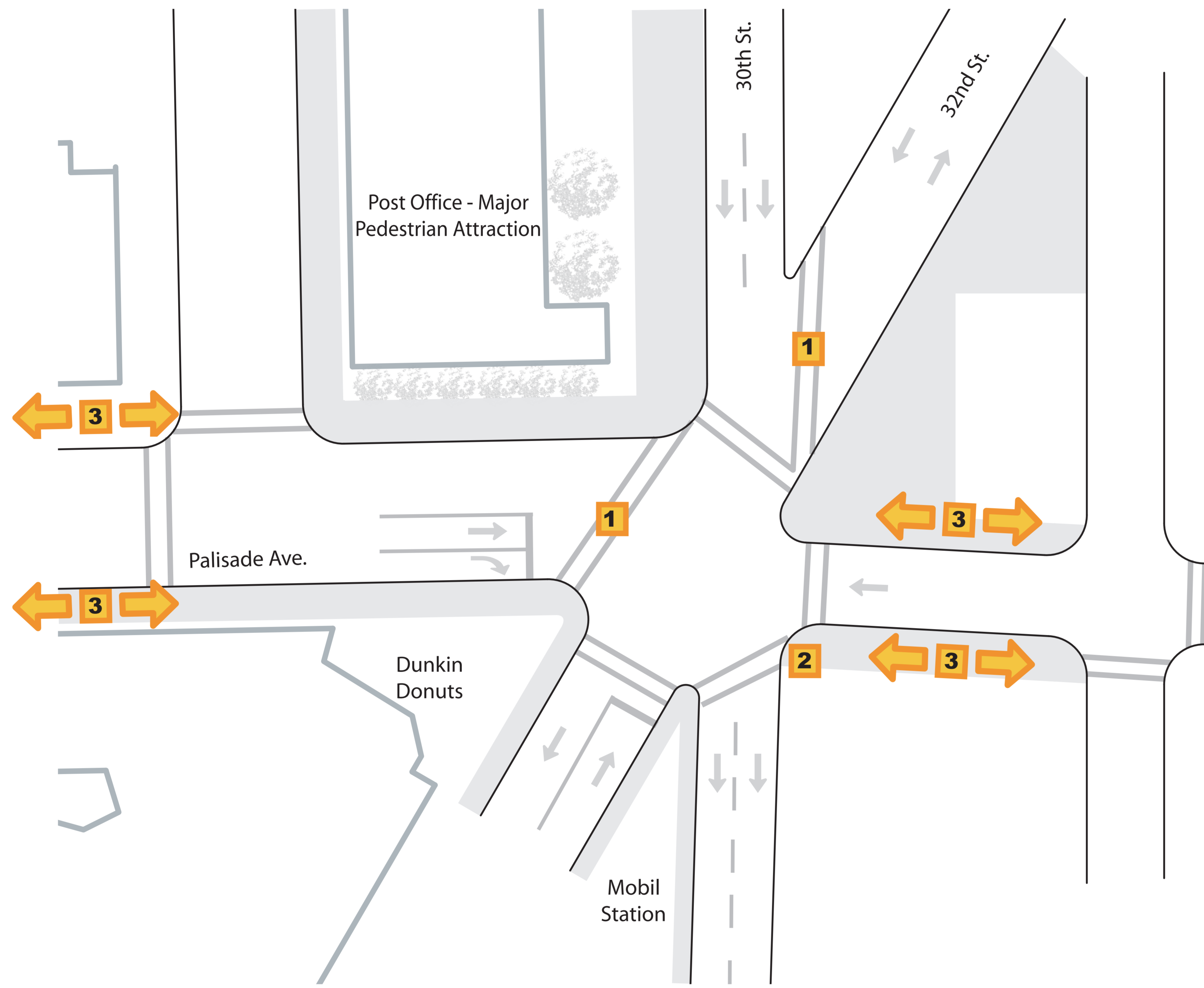
PLANS PREPARED FOR:
**NORTH HUDSON COUNTY
 BICYCLE AND PEDESTRIAN STUDY**



TRAFFIC ISSUES AND CONFLICTS

-  Motorized Conflicts
-  Pedestrian Conflicts
-  Pedestrian Movement Direction

1. Very long pedestrian crossing
2. Pedestrian signal head obscured by chain link fence from view across 30th St.
3. Major pedestrian movements

The RBA Group, Inc.
 ENGINEERS ARCHITECTS PLANNERS
 One Evergreen Place
 Morristown, New Jersey 07062
 Phone (973) 898 0300, Fax (973) 898-9472

REVISIONS		
NO.	DATE	COMMENTS

TRAFFIC ISSUES & CONFLICTS

**HAKCENSACK PLANK RD
 PALISADE AVENUE AND
 30TH STREET**

DATE: MAY 17, 2005
 JOB NUMBER: J3536.00
 SCALE: 1"=50'
 DRAWN BY: KC
 CHK. BY: MD

SITE NUMBER
4

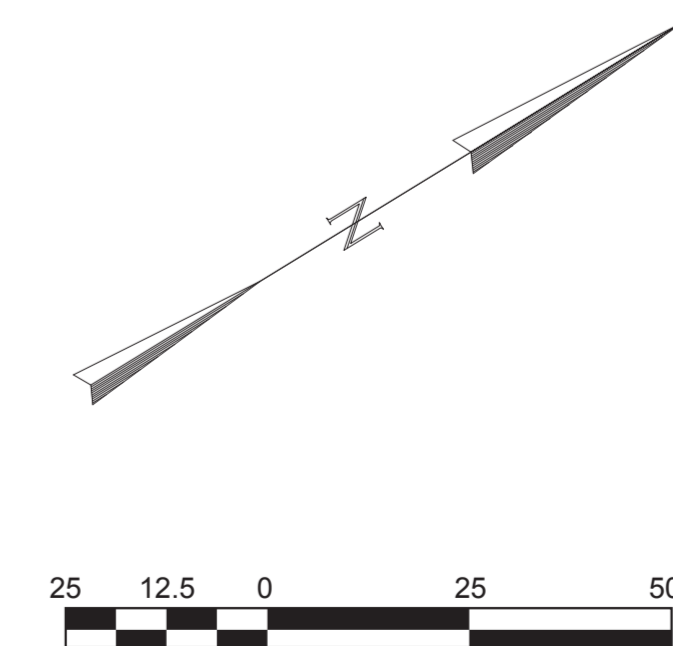

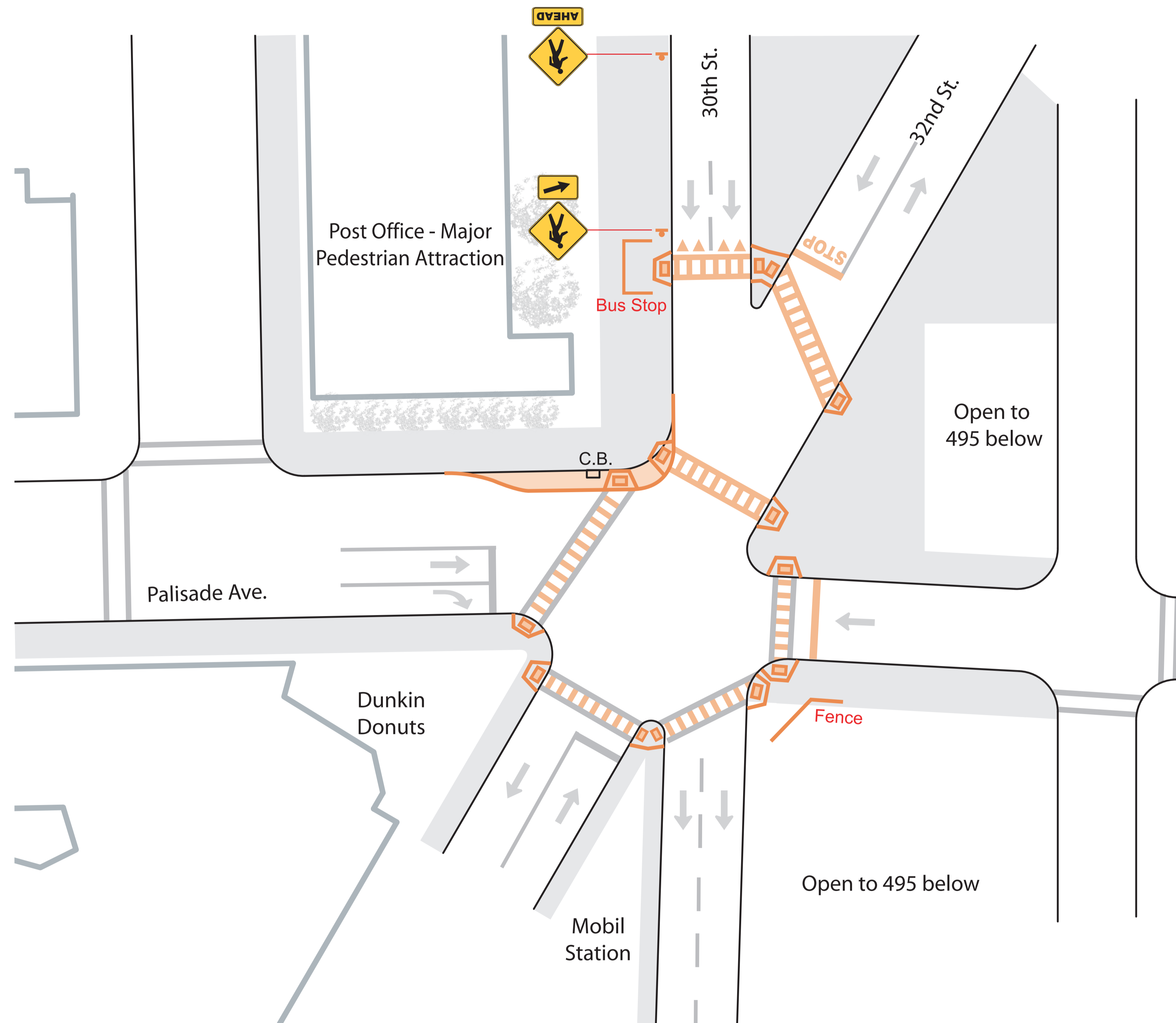

RECOMMENDATIONS

1. Adjust fencing to not obstruct existing pedestrian signal head
2. Provide detectable warning across all curb ramps
3. Realign crosswalk to decrease crossing distance and match typical pedestrian pattern
4. Provide curb extension to decrease pedestrian crossing distance and improve visibility
5. Provide high visibility ladder style striping for all crosswalks

PLANS PREPARED FOR:
**NORTH HUDSON COUNTY
 BICYCLE AND PEDESTRIAN STUDY**



REVISIONS		
NO.	DATE	COMMENTS

RECOMMENDATIONS

**HAKCENSACK PLANK RD
 PALISADE AVENUE AND
 30TH STREET**

DATE: MAY 17, 2005
 JOB NUMBER: J3536.00
 SCALE: 1"=50'
 DRAWN BY: KC
 CHK. BY: MD

SITE NUMBER
4

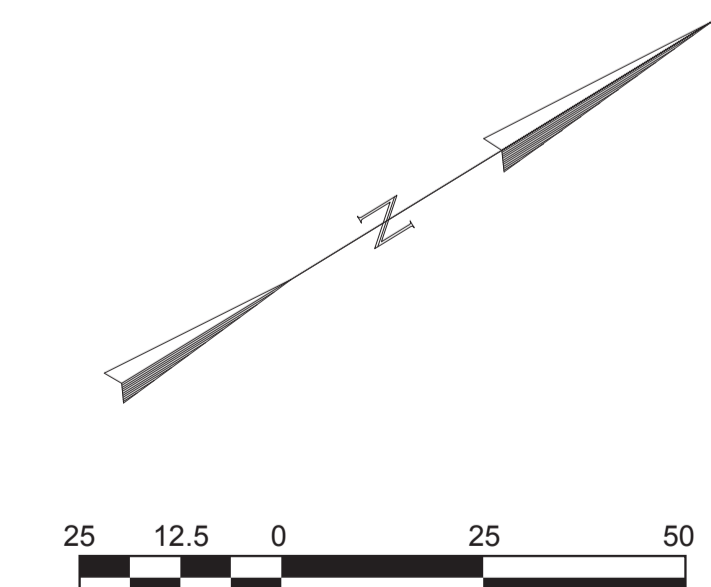

North Hudson County Pedestrian and Bicycle Study
Preliminary Cost Estimate for Site Work
El Taller Colaborativo, P.C.

June, 2005

Site Number 4 - Hackensack Plank Rd. Palisade Avenue and 30th Street

<i>IMPROVEMENT</i>	<i>QUANTITY</i>	<i>UNIT</i>	<i>UNIT PRICE</i>		<i>TOTAL</i>
Clearing Site				\$	2,000.00
Construction Layout				\$	3,000.00
Remove existing concrete sidewalk	2,530	sq.ft.	\$ 2.30	\$	5,819.00
Remove existing concrete curb	440	lin.ft.	\$ 4.30	\$	1,892.00
New concrete curb	450	lin.ft.	\$ 18.00	\$	8,100.00
New concrete pavement	3,130	sq.ft.	\$ 4.00	\$	12,520.00
Detectable warning panel at ramps	14	each	\$ 385.00	\$	5,390.00
Asphalt removal	600	sq.ft.	\$ 2.00	\$	1,200.00
Asphalt pavement replacement along new curb	1,350	sq.ft.	\$ 5.00	\$	6,750.00
Crosswalk striping	1,140	lin.ft.	\$ 2.00	\$	2,280.00
Stop bar and lane striping	52	lin.ft.	\$ 5.75	\$	299.00
Other striping	250	sq.ft.	\$ 2.60	\$	650.00
Adjustment to fencing	34	lin.ft.	\$ 50.00	\$	1,700.00
New sign	2	each	\$ 165.00	\$	330.00
Relocation of drainage structures and other utilities	1	l.s.	\$ -	\$	16,950.00
			Sub-total	\$	68,880.00
Traffic Maintenance			7%	\$	4,821.60
Mobilization			9%	\$	6,199.20
			20% contingency	\$	13,776.00
			Total	\$	68,880.00